



SD SERIES 20 NPT OIL HOSE REEL

The SD line of hose reels feature Graco durability, performance and value built into every reel. With its durable metal spool and rigid pedestal frame, the compact SD Series is ideal for indoor and moderate outdoor exposure.

FEATURES & BENEFITS:

- Full-Flow Swivel - Maximize material flow with minimal pressure drop for faster fills to get more vehicles through your shop.
- Adjustable Arm - Easily change to one of six arm positions to fit your application.
- Large Hose Capacity with Small Profile - Compact pedestal and spool fits into tight spaces and can accommodate 35-65 foot (10.7-19.8 meters) hose (NPT air/water) capacity for a wide variety of applications.
- Durable Finish - Baked-on enamel finish protects reel from corrosion.

APPLICATIONS:

- Car dealerships
- Light-/medium-duty truck dealers
- Fleet maintenance
- Public works garages
- Construction vehicle maintenance
- Light-utility service trucks



PART NO.		LENGTH	WEIGHT	DIMENSIONS
AF-G-25P962	GRACO SD Series 20 NPT Oil Reel - 15m x 1/2" ID Hose - White	15m	27 Kg	50x20x56

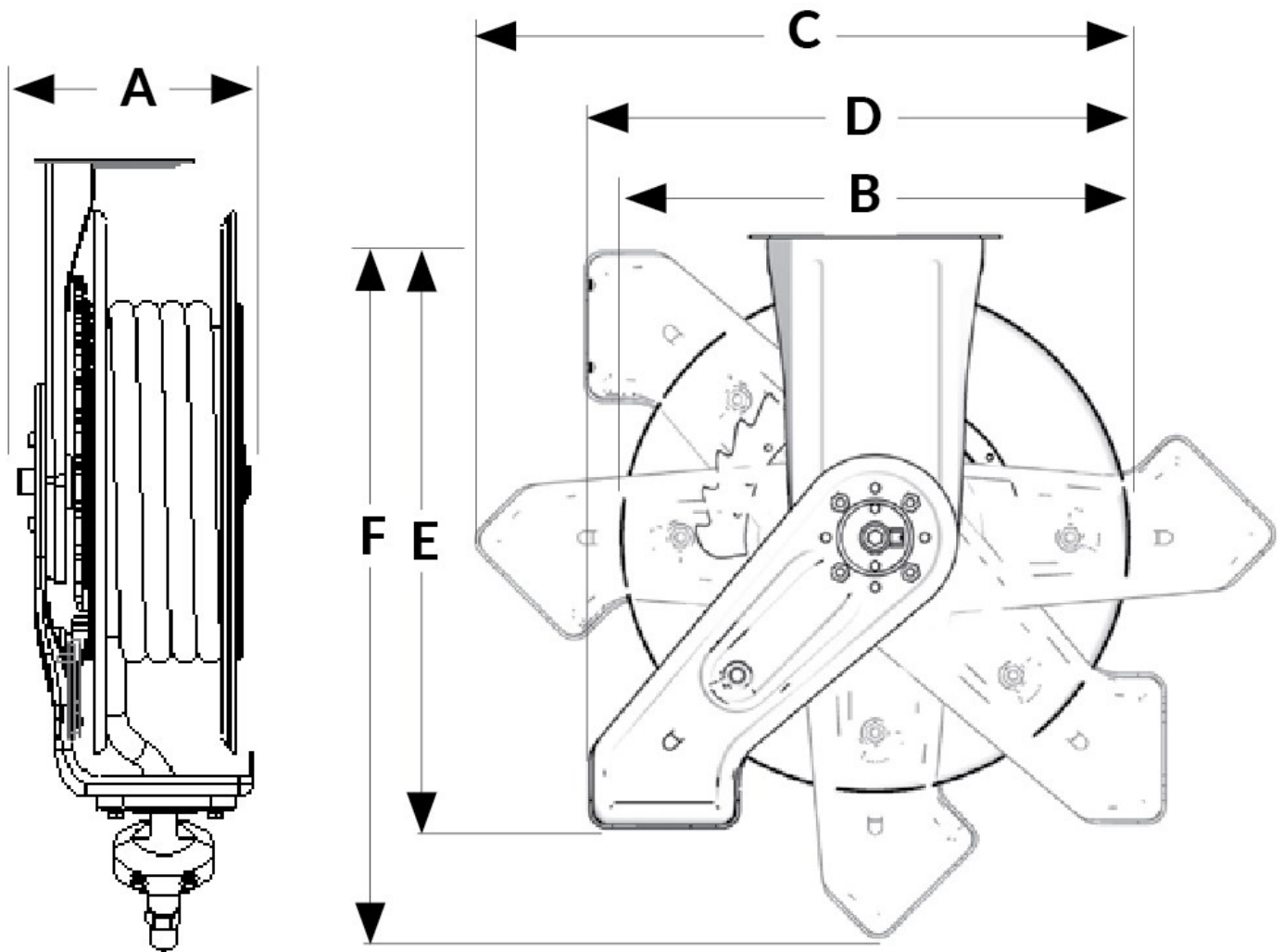



WALL MOUNT

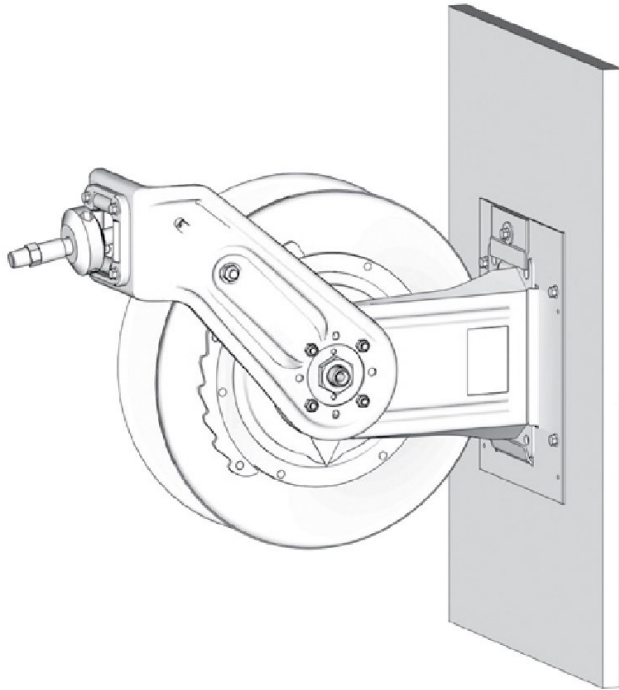

CEILING MOUNT

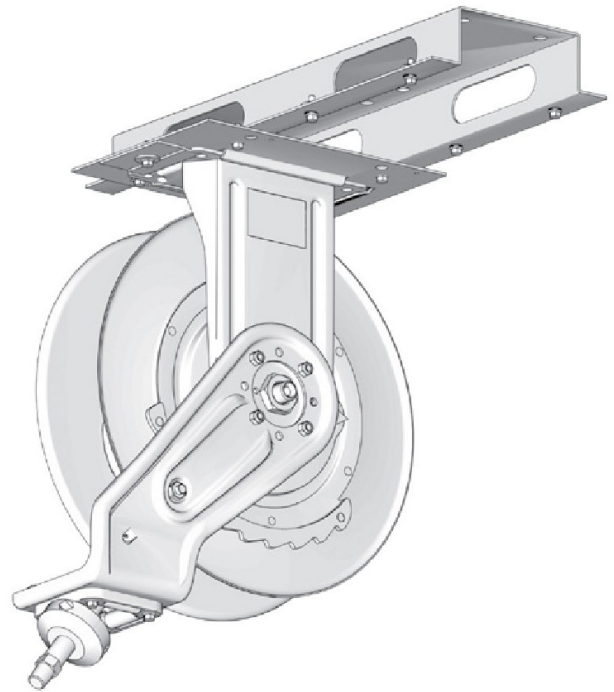

BENCH/TRUCK MOUNT

